

LEGEND

- VEGETATED SWALES
- PROPRIETARY TREATMENT
- RAINGARDEN TREATMENT SYSTEMS
- LANDSCAPE WETLAND PLANTING
- POTENTIAL ALTERNATIVE ALIGNMENT
- LARGE CULVERT UPGRADE
- OPEN CHANNEL / STREAM
- RISING MAIN
- PROPOSED DIAMETER FOR NEW CULVERT
- EXISTING STORMWATER CULVERT
- PROPOSED STORM WATER MANHOLE
- STORMWATER PUMP STATION
- PIPE OUTLET NUMBER
- NEW RIVER ALIGNMENT
- EXISTING RIVER BED
- ABANDONED EXISTING SW CULVERT
- FILLED IN STREAM

- GENERAL NOTES:**
1. THE DRAWINGS ONLY INCLUDES DRAINAGE AND SOME SERVICES ONLY.
 2. WHERE PROPERTIES ARE BEING DEMOLISHED, ALL SERVICES TO THESE PROPERTIES WOULD NEEDS TO BE CAPPED OFF AT THE RELEVANT SERVICES MAINS.

| | | | | | |
|-------|------------------------------------|----------|---|------|----------|
| E | RESOURCE CONSENT - UPDATED FOR S92 | DM | AI* | Awh* | 25.01.22 |
| D | RESOURCE CONSENT | RK | SJ* | Awh* | 08.07.21 |
| C | DESIGN FREEZE 2 - FINAL | NM | SJ* | Awh* | 28.05.21 |
| B | DESIGN FREEZE 2 | RG | SJ* | Awh* | 26.03.21 |
| A | DESIGN FREEZE 2 - FOR REVIEW | RG | | | |
| No | Revision | Note: | * Indicates signatures on original issue of drawing or last revision of drawing | | |
| Drawn | Checked | Approved | Date | | |



RiverLink

Isthmus. **Tonkin+Taylor** **GHD** **Holmes**

DO NOT SCALE

COPYRIGHT ISTHMUS GROUP LIMITED®
This document may only be used by Isthmus' client (and any other person who Isthmus has agreed can use this document) for the purpose for which it was prepared and must not be used by any other person or for any other purpose.

| | | | |
|----------------|-------------|--|-----------|
| Drawn | R. GERONIMO | Designed | A. INGLIS |
| Drafting Check | | Design Check | |
| Approved | | Date | |
| Scale | 1:1000 | This Drawing must not be used for construction unless signed as Approved | |

Client RIVERLINK
Project RIVERLINK
Title PROPOSED DRAINAGE SERVICE WORKS
SHEET 1 OF 4

Original Size A1
Drawing No: A16-4381-C321
Rev: E

PRELIMINARY

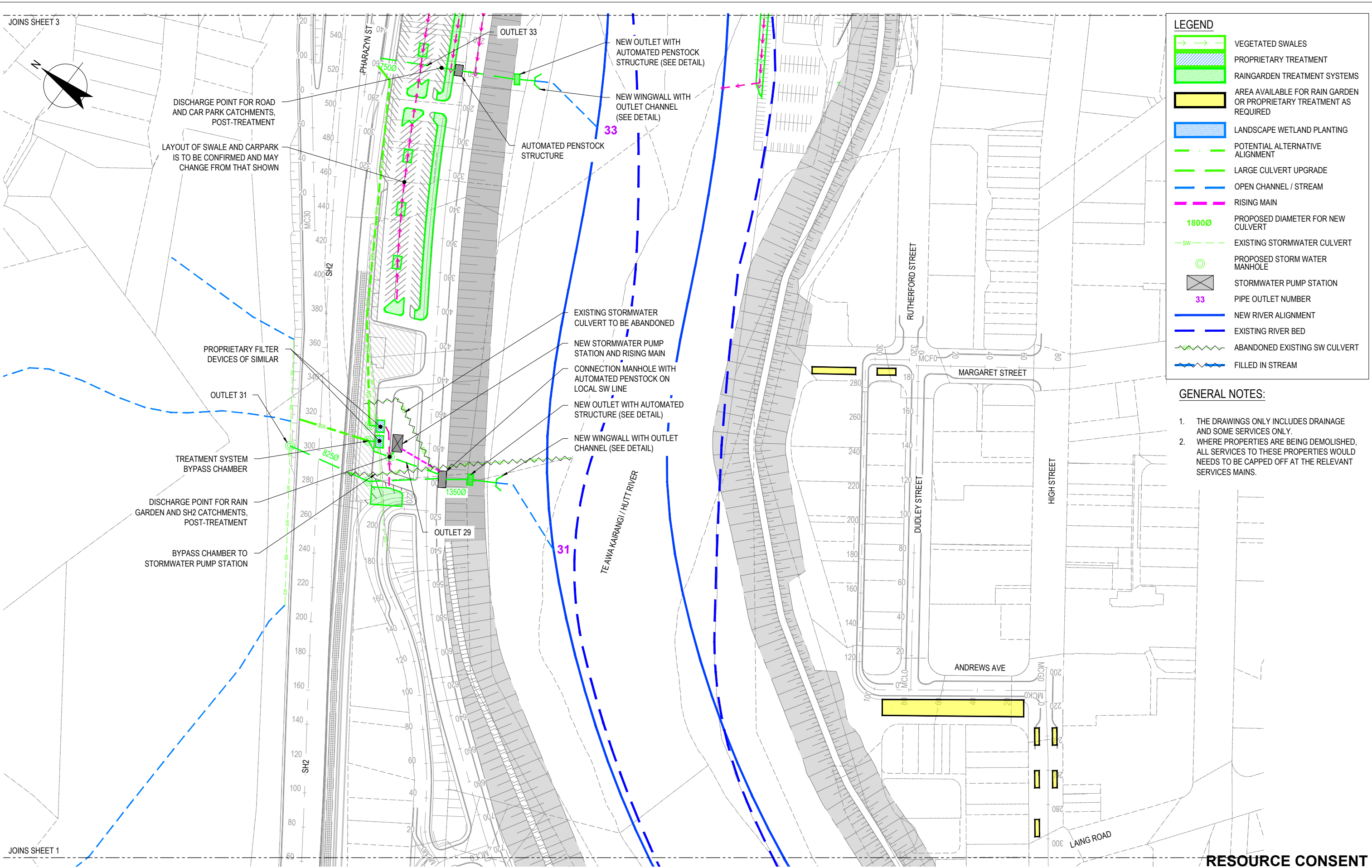

LEGEND

- VEGETATED SWALES
- PROPRIETARY TREATMENT
- RAINGARDEN TREATMENT SYSTEMS
- AREA AVAILABLE FOR RAIN GARDEN OR PROPRIETARY TREATMENT AS REQUIRED
- LANDSCAPE WETLAND PLANTING
- POTENTIAL ALTERNATIVE ALIGNMENT
- LARGE CULVERT UPGRADE
- OPEN CHANNEL / STREAM
- RISING MAIN
- PROPOSED DIAMETER FOR NEW CULVERT
- EXISTING STORMWATER CULVERT
- PROPOSED STORM WATER MANHOLE
- STORMWATER PUMP STATION
- PIPE OUTLET NUMBER
- NEW RIVER ALIGNMENT
- EXISTING RIVER BED
- ABANDONED EXISTING SW CULVERT
- FILLED IN STREAM

- GENERAL NOTES:**
1. THE DRAWINGS ONLY INCLUDES DRAINAGE AND SOME SERVICES ONLY.
 2. WHERE PROPERTIES ARE BEING DEMOLISHED, ALL SERVICES TO THESE PROPERTIES WOULD NEEDS TO BE CAPPED OFF AT THE RELEVANT SERVICES MAINS.

RESOURCE CONSENT

| | | | | | | |
|----|--------------------------------------|---|-------|---------------|----------|------|
| F | INCLUSION OF S92 RESPONSE AMENDMENTS | NM | | | | |
| E | RESOURCE CONSENT - UPDATED FOR S93 | DM | AI* | AWh* 25.01.22 | | |
| D | RESOURCE CONSENT | RK | SJ* | AWh* 08.07.21 | | |
| C | DESIGN FREEZE 2 - FINAL | NM | SJ* | AWh* 28.05.21 | | |
| B | DESIGN FREEZE 2 | RG | SJ* | AWh* 26.03.21 | | |
| No | Revision | Note: * indicates signatures on original issue of drawing or last revision of drawing | Drawn | Checked | Approved | Date |

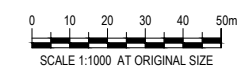

RiverLink

Isthmus. **Tonkin+Taylor** **GHD** **Holmes**

DO NOT SCALE

COPYRIGHT ISTHMUS GROUP LIMITED
This document may only be used by Isthmus' client (and any other person who Isthmus has agreed can use this document) for the purpose for which it was prepared and must not be used by any other person or for any other purpose.

| | | | |
|----------------|-------------|--------------|-----------|
| Drawn | R. GERONIMO | Designed | A. INGLIS |
| Drafting Check | | Design Check | |
| Approved | | | |
| Date | | | |
| Scale | 1:1000 | | |

Client **RIVERLINK**

Project **RIVERLINK**

Title **PROPOSED DRAINAGE SERVICE WORKS SHEET 2 OF 6**

Original Size **A1** Drawing No: **A16-4381-C322** Rev: **F**

This Drawing must not be used for Construction unless signed as Approved

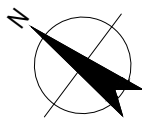

LEGEND

- VEGETATED SWALES
- PROPRIETARY TREATMENT
- RAINGARDEN TREATMENT SYSTEMS
- LANDSCAPE WETLAND PLANTING
- POTENTIAL ALTERNATIVE ALIGNMENT
- LARGE CULVERT UPGRADE
- OPEN CHANNEL / STREAM
- RISING MAIN
- PROPOSED DIAMETER FOR NEW CULVERT
- EXISTING STORMWATER CULVERT
- PROPOSED STORM WATER MANHOLE
- STORMWATER PUMP STATION
- PIPE OUTLET NUMBER
- NEW RIVER ALIGNMENT
- EXISTING RIVER BED
- ABANDONED EXISTING SW CULVERT
- FILLED IN STREAM

- GENERAL NOTES:**
1. THE DRAWINGS ONLY INCLUDES DRAINAGE AND SOME SERVICES ONLY.
 2. WHERE PROPERTIES ARE BEING DEMOLISHED, ALL SERVICES TO THESE PROPERTIES WOULD NEEDS TO BE CAPPED OFF AT THE RELEVANT SERVICES MAINS.

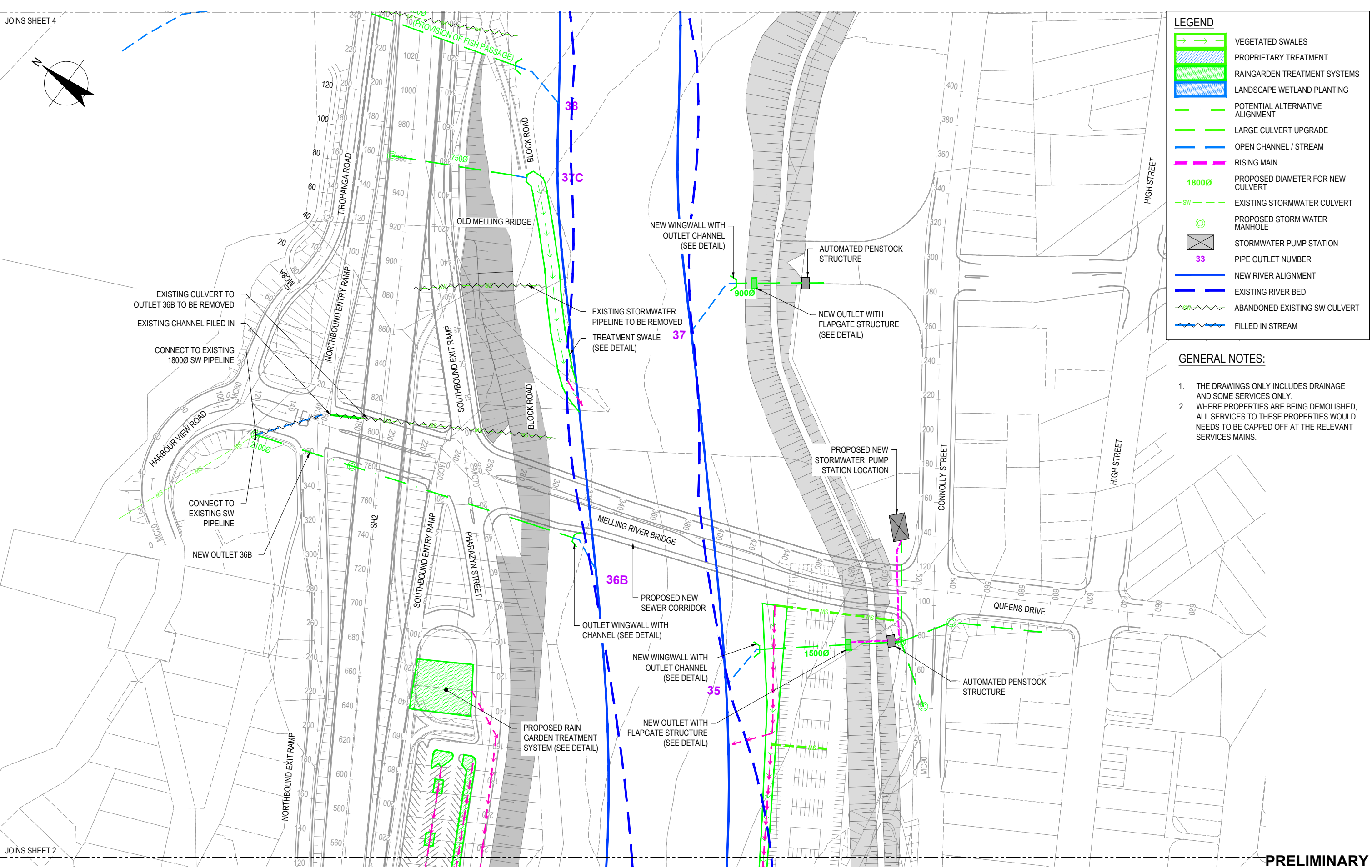

PRELIMINARY

| | | | | | |
|-------|------------------------------------|----------|---|------|----------|
| E | RESOURCE CONSENT - UPDATED FOR S94 | DM | AI* | Awh* | 25.01.22 |
| D | RESOURCE CONSENT | RK | SJ* | Awh* | 08.07.21 |
| C | DESIGN FREEZE 2 - FINAL | NM | SJ* | Awh* | 28.05.21 |
| B | DESIGN FREEZE 2 | RG | SJ* | Awh* | 26.03.21 |
| A | DESIGN FREEZE 2 - FOR REVIEW | RG | | | |
| No | Revision | Note: | * Indicates signatures on original issue of drawing or last revision of drawing | | |
| Drawn | Checked | Approved | Date | | |

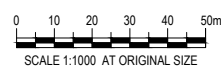

RiverLink

Isthmus. **Tonkin+Taylor** **GHD** **Holmes**

DO NOT SCALE

COPYRIGHT ISTHMUS GROUP LIMITED
This document may only be used by Isthmus' client (and any other person who Isthmus has agreed can use this document) for the purpose for which it was prepared and must not be used by any other person or for any other purpose.

| | | | |
|----------------|-------------|--|-----------|
| Drawn | R. GERONIMO | Designed | A. INGLÉS |
| Drafting Check | | Design Check | |
| Approved | | | |
| Date | | | |
| Scale | 1:1000 | This Drawing must not be used for Construction unless signed as Approved | |

Client **RIVERLINK**

Project **RIVERLINK**

Title **PROPOSED DRAINAGE SERVICE WORKS SHEET 3 OF 4**

Original Size **A1** Drawing No: **A16-4381-C323** Rev: **E**

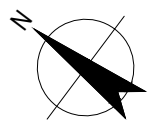

LEGEND

- VEGETATED SWALES
- PROPRIETARY TREATMENT
- RAINGARDEN TREATMENT SYSTEMS
- LANDSCAPE WETLAND PLANTING
- POTENTIAL ALTERNATIVE ALIGNMENT
- LARGE CULVERT UPGRADE
- OPEN CHANNEL / STREAM
- RISING MAIN
- PROPOSED DIAMETER FOR NEW CULVERT
- EXISTING STORMWATER CULVERT
- PROPOSED STORM WATER MANHOLE
- STORMWATER PUMP STATION
- PIPE OUTLET NUMBER
- NEW RIVER ALIGNMENT
- EXISTING RIVER BED
- ABANDONED EXISTING SW CULVERT
- FILLED IN STREAM

- GENERAL NOTES:**
1. THE DRAWINGS ONLY INCLUDES DRAINAGE AND SOME SERVICES ONLY.
 2. WHERE PROPERTIES ARE BEING DEMOLISHED, ALL SERVICES TO THESE PROPERTIES WOULD NEEDS TO BE CAPPED OFF AT THE RELEVANT SERVICES MAINS.

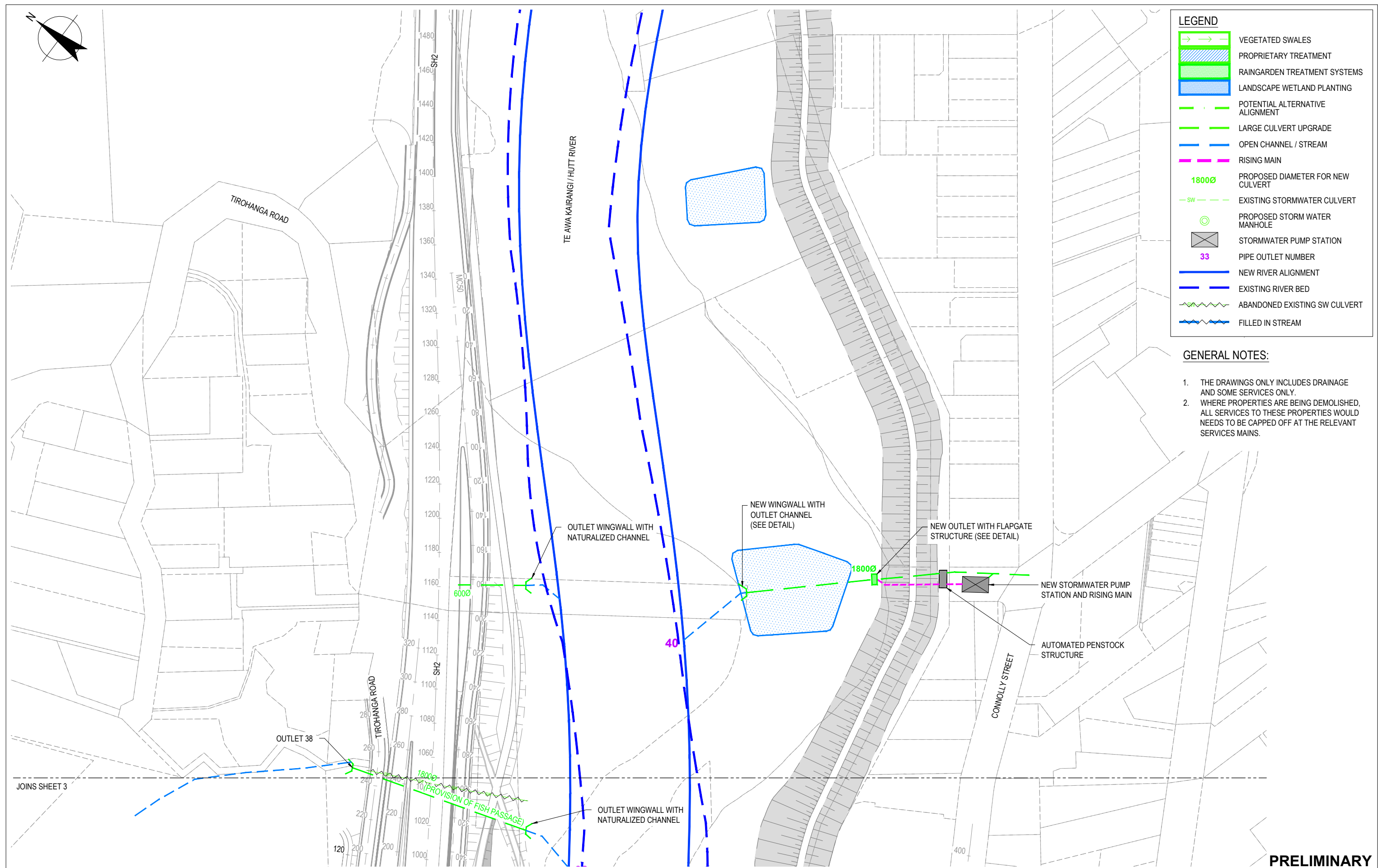

| | | | | | | | |
|----|------------------------------------|-------|---|-------|----------|----------|------|
| E | RESOURCE CONSENT - UPDATED FOR S95 | DM | AI* | Awh* | 25.01.22 | | |
| D | RESOURCE CONSENT | RK | SJ* | Awh* | 08.07.21 | | |
| C | DESIGN FREEZE 2 - FINAL | NM | SJ* | Awh* | 28.05.21 | | |
| B | DESIGN FREEZE 2 | RG | SJ* | Awh* | 26.03.21 | | |
| A | DESIGN FREEZE 2 - FOR REVIEW | RG | | | | | |
| No | Revision | Note: | * Indicates signatures on original issue of drawing or last revision of drawing | Drawn | Checked | Approved | Date |



RiverLink

Isthmus. **Tonkin + Taylor** **GHD** **Holmes**

DO NOT SCALE

COPYRIGHT ISTHMUS GROUP LIMITED©
This document may only be used by Isthmus' client (and any other person who Isthmus has agreed can use this document) for the purpose for which it was prepared and must not be used by any other person or for any other purpose.

| | | | |
|----------------|-------------|--------------|-----------|
| Drawn | R. GERONIMO | Designed | A. INGLES |
| Drafting Check | | Design Check | |
| Approved | | | |
| Date | | | |
| Scale | 1:1000 | | |

PRELIMINARY

Client **RIVERLINK**
Project **RIVERLINK**
Title **PROPOSED DRAINAGE SERVICE WORKS SHEET 4 OF 4**

Original Size **A1** Drawing No: **A16-4381-C324** Rev: **E**

This Drawing must not be used for construction unless signed as Approved